

Product Zebra Technologies Corporation

Producer 1 Zebra Plaza
Holtsville, NY 11742

Product Models: XSLATE, XPAD
Description Rugged Tablet

Hazardous Substances and Preparations The materials used in this product are RoHS compliant. This product contains the following items that may require special handling:

- LCD (#1)
- PC Board (#27)
- Battery (#26)

Batteries This product contains a removable lithium-ion (Li-Ion) type battery located at the back of the product. The battery clips into this product and can be removed without the use of tools. Battery removal instructions and method of attachment details can be found in the [product user guide](#). This battery must be disposed of in accordance with local regulations.

Packaging The packaging materials used for this product do not contain any of the banned materials listed in the EU packaging directive.

The printed user documentation included with this product is produced on paper with 50% or more recycled content that has not been bleached with chlorine.

Information on the assessment of the packaging scheme for this or other Zebra products can be found at: <http://www.zebra.com/environment>.

Recycling Information Zebra Technologies offers product recycling programs in certain geographic areas. To determine if a program is available for this product in your area, please refer to our web site at: <http://www.zebra.com/environment>.

This product is designed with the following features to enhance recycling:

- Glues and adhesives have been eliminated from product construction where feasible.
- Use of common fasteners and/or snap-in features

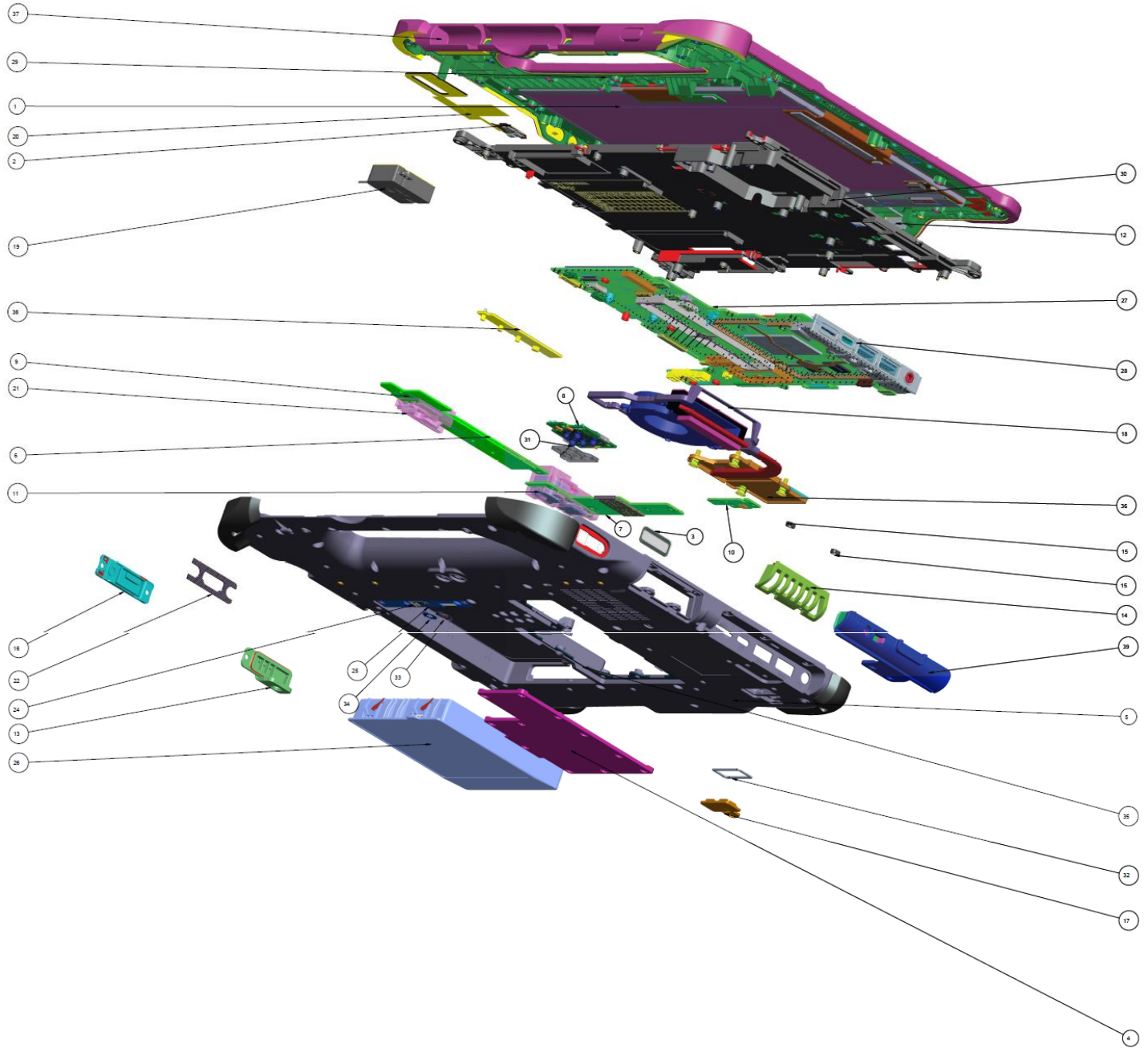



39	1	LYNX10_DOOR_IO_ASSY
38	1	LYNX_TOP_CASE_LED_LENS_ASM
37	1	LYNX_TOP_CASE_H
36	1	LYNX_THM_KBL-RU_ASSY
35	1	LYNX_SEAL_RUBBER_BOTCASE_DOOR
34	1	LYNX_REAR_CAM_FLASH_PLATE
33	1	LYNX_REAR_CAM_CLEAR_PLATE
32	1	LYNX_OPTION_DOOR_SPONGE
31	1	LYNX_NEW_RF_PASS_THRU_SPONGE
30	1	LYNX_MIDDLE_FRAME_K
29	2	LYNX_MIC_VENT
28	1	LYNX_MB_SEAL_RUBBER
27	1	LYNX_MB_KBL_ASM
26	1	LYNX_MAIN_HARD_PACK_ASM
25	1	LYNX_MAIN_BATT_LATCH_COVER
24	1	LYNX_MAIN_BATT_LATCH_050_60_T
23	1	LYNX_LCD_MYLAR_WO_ATEX_ASM
22	1	LYNX_HDMI_DOOR_SEAL_RUBBER_BTM
21	1	LYNX_HDMI_DB_SEAL_RUBBER
20	1	LYNX_FRONT_SPEAKER_CU_FOIL_1
19	1	LYNX_FRONT_SPEAKER
18	1	LYNX_FAN_SEAL_RUBBER_PVT_ASM
17	1	LYNX_DOOR_OPTION
16	1	LYNX_DOOR_HDMI
15	2	LYNX_DOOR_FAN_COVER_RUBBER
14	1	LYNX_DOOR_FAN_COVER
13	1	LYNX_DOOR_DC_IN
12	1	LYNX_DOCK_CONNECTOR_ASM
11	1	LYNX_DC_DB_SEAL_RUBBER-1
10	1	LYNX_DB_WIN-KEY
9	1	LYNX_DB_RS232
8	1	LYNX_DB_NEW_RF-PASS-THRU_ASSY
7	1	LYNX_DB_LAN
6	1	LYNX_DB_FUN
5	1	LYNX_BOT_CASE_W_H_SUB_ASM
4	1	LYNX_BOT_CASE_DOOR_ASSY
3	1	LYNX_BARCODE_LENS
2	1	FAO2C70239QR-B-E-FZ1030
1	1	00_LYNX_LCD_ASSY_PANASONIC
Item	Qty	Fine Name

This document was compiled from information available at the time of publication and is issued only as an information source. No warranty as to accuracy or completeness is expressed or implied. This document is subject to change without notice.